

Dimension:
Unit=mm

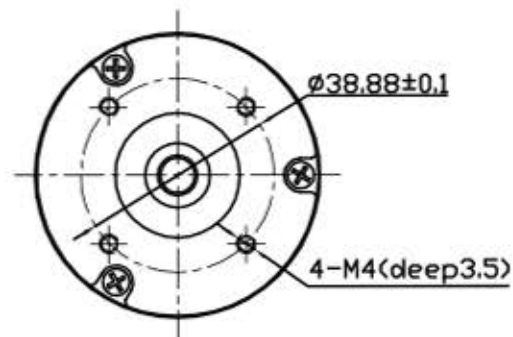

Connection diagram:

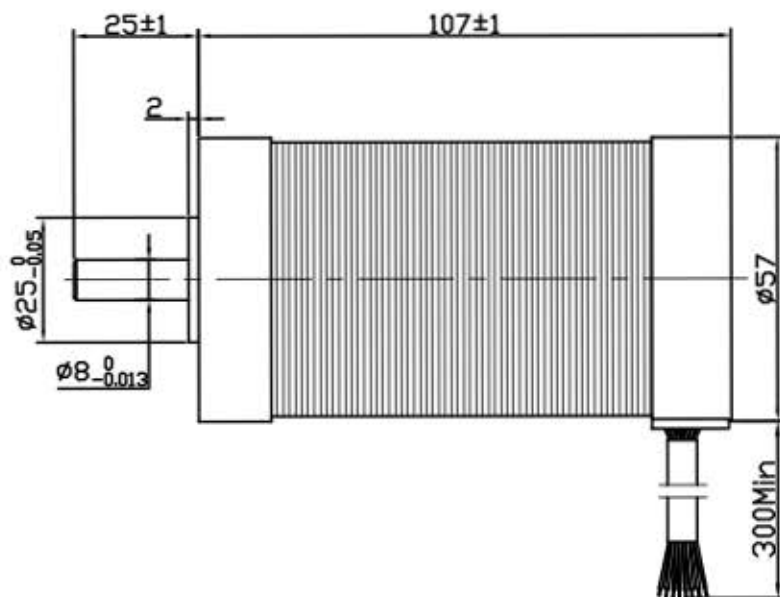
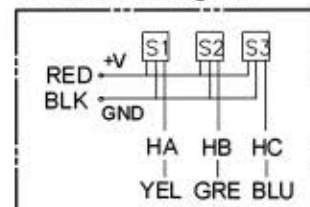

Hall sensor cable
Note: hall sensor power supply
voltage +5 to +20VDC

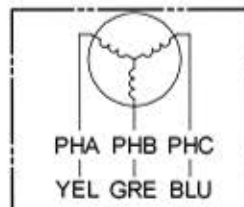

Wiring cable

ROTATION: CCW SEE FROM LEAD END

| | |
|---------------------------|---------------|
| MANUFACTURER MODEL | JK57BLS04 |
| NUMBER OF POLES | 4 |
| PHASE TO PHASE RESISTANCE | 0.42 OHMS |
| NOMINAL VOLTAGE | 36 VDC |
| NO LOAD SPEED | 4800±10% RPM |
| NO LOAD CURRENT | 0.9 Amps Max. |
| RATED TORQUE | 0.44 N-m |
| RATED SPEED | 4000±10% RPM |
| OUTPUT POWER | 184 W |
| BACK EMF CONSTANT | 7.5 V/kRPM |
| TORQUE CONSTANT | 0.072 N-m/A |
| INSULATION CLASS | B |

ELECTRICAL CONNECTION TABLE

| | | | |
|---------|-----|---|-----------------|
| +5V | RED | 红 | UL1007 26AWG |
| HALL U | YEL | 黄 | |
| HALL V | GRE | 绿 | |
| HALL W | BLU | 蓝 | |
| GND | GND | 黑 | |
| PHASE U | YEL | 黄 | UL1007 18AWG |
| PHASE V | GRE | 绿 | |
| PHASE W | BLU | 蓝 | |

| | | |
|--------|-------|------|
| REV. | SIG. | DATE |
| DESIGN | STD. | |
| CHECK | | |
| PROC. | APPR. | |

| | | | | | |
|---------------|--------|-------|---------------|--|--|
| Title: | | | 常州倍士福机电有限公司 | | |
| Specification | | | BFBLS04 | | |
| CLS.MAK | WEIGHT | SCALE | www.besfoc.cn | | |
| PAGE: | | 1/1 | | | |